



172 Richmond Road

, Gillingham, ME7 1LX

Guide Price £280,000



Virtual tour available

Nestled on the charming Richmond Road in Gillingham, this Victorian mid-terrace house is a true gem waiting to be discovered. With many period features including four decorative fire places, original 1900's tile and boasting two reception rooms, four bedrooms, and a bathroom, this property offers ample space for comfortable living. Spread across three floors plus a cellar, this house presents versatile rooms that can be tailored to suit your needs. Whether you're looking for an investor's dream or a home renovation project, this property has the potential to be transformed into something truly special.

Conveniently located with permit parking available, this residence is in close proximity to supermarkets, schools, colleges, and universities, making it an ideal choice for families or individuals alike. With no forward chain, a council tax band C, and an EPC rating of C, this property is not to be missed.

Don't miss out on the opportunity to own a piece of Victorian charm in a thriving community. Book a viewing today and let your imagination run wild with the possibilities this property has to offer.

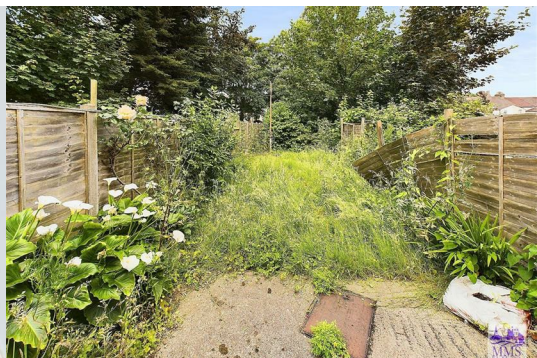

entrance hall
 lounge
 bedroom/reception
 stairs to first
 bedroom
 bedroom
 stairs to lower ground
 bedroom/reception
 kitchen/diner
 lobby
 bathroom
 cellar

Area Map



Floor Plans

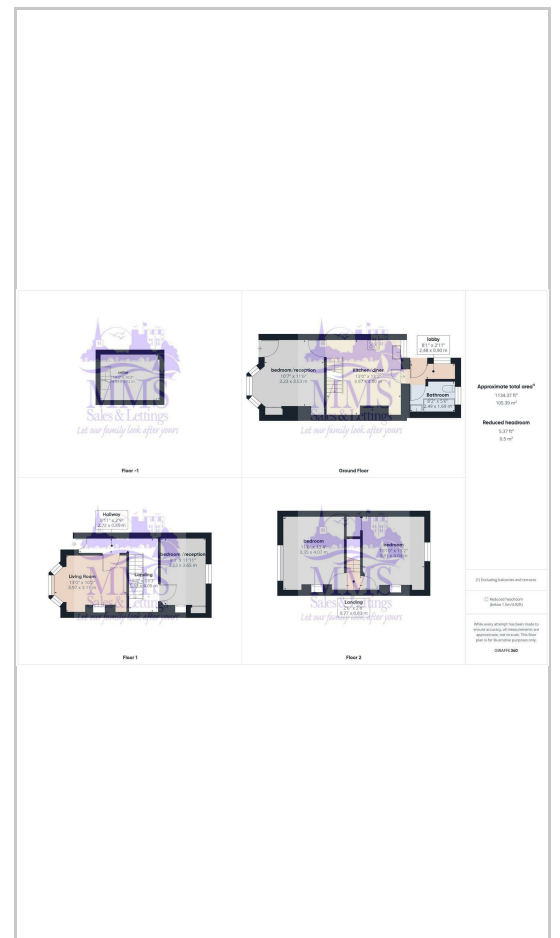

Energy Efficiency Graph

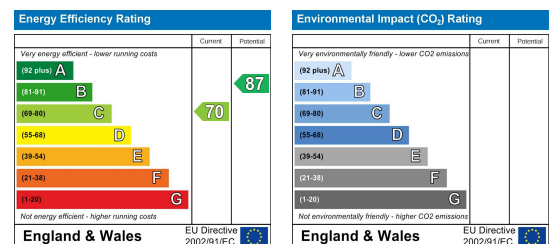

These particulars, whilst believed to be accurate are set out as a general outline only for guidance and do not constitute any part of an offer or contract. Intending purchasers should not rely on them as statements of representation of fact, but must satisfy themselves by inspection or otherwise as to their accuracy. No person in this firm's employment has the authority to make or give any representation or warranty in respect of the property.